

SEÇÃO TRANSVERSAL vias com paralelepípedo

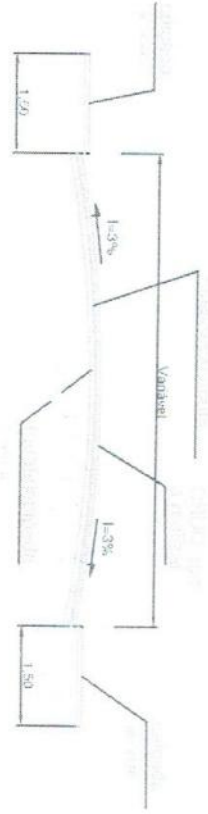

SEÇÃO TRANSVERSAL vias com asfalto



PLACA RUA

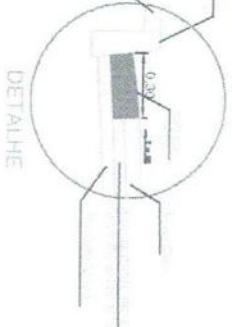

DETALHE

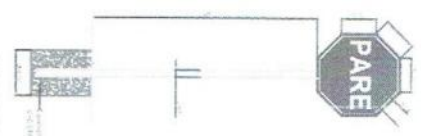

SINALIZAÇÃO VERTICAL

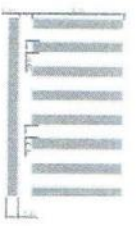

SINALIZAÇÃO HORIZONTAL

- CONVENÇÕES:
- RAMPA PNE EXISTENTE
 - ▨ RAMPA PNE M01
 - ▧ RAMPA PNE M02
 - ➔ SENTIDO TRANSITO
 - (B) BOCA DE LOTO EXISTENTE
 - ➔ SENTIDO ESCOAMENTO DE AGUA

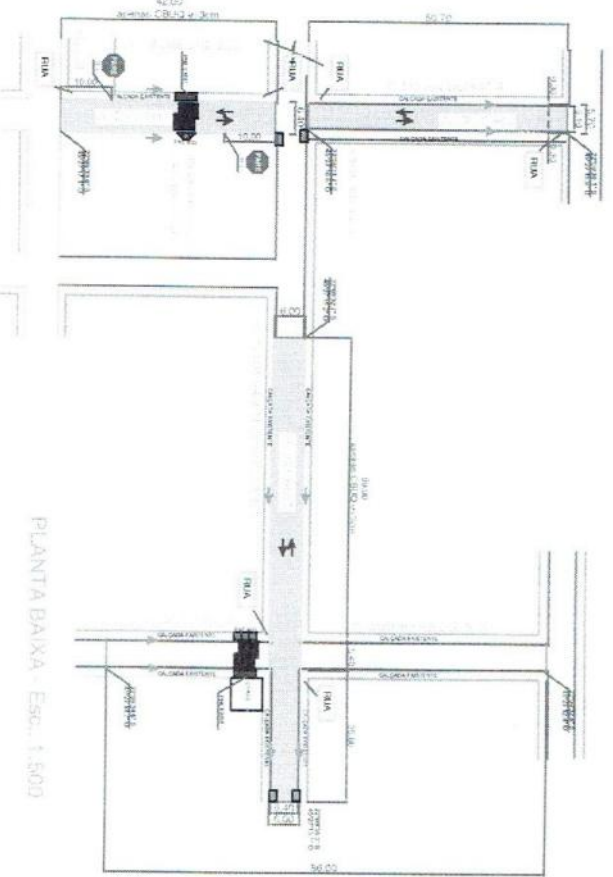

PLANTA BAIXA ESC. 1:500

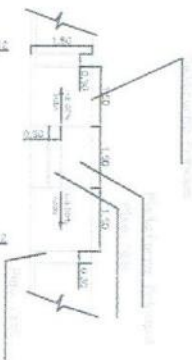

DET. RAMPA PNE - ESC. 1:20

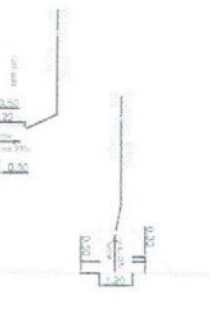

DET. RAMPA PNE - ESC. 1:20

JOSÉ AIRTON PEREIRA*
PREFEITO MUNICIPAL

Sebastião Rodrigues Florencio
Engenheiro Civil
REA 9799 - AMASP

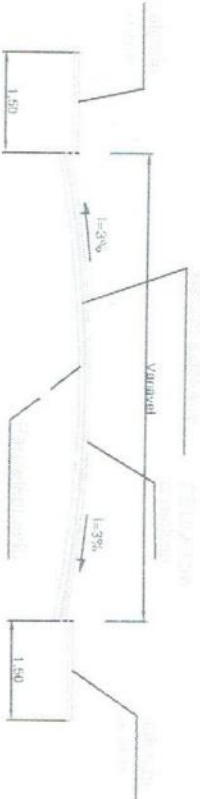
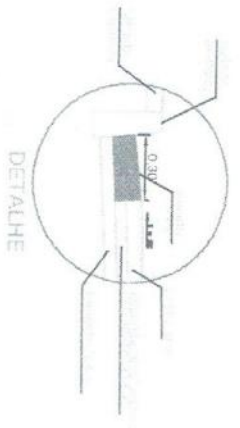
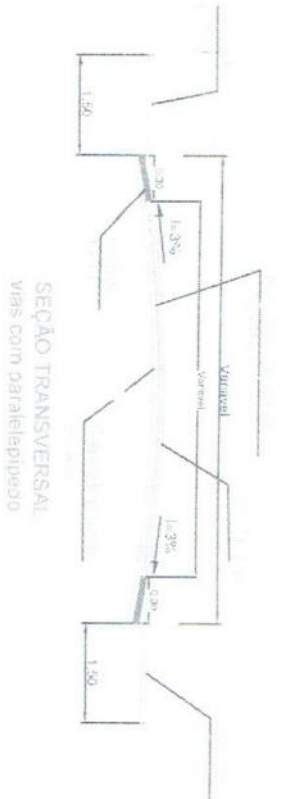
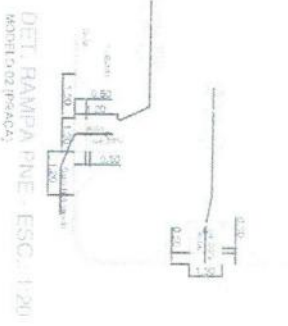
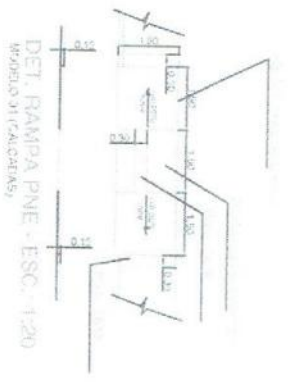

- CONVENÇÕES:**
- RAMPA PNE EXISTENTE
 - ▨ RAMPA PNE M01
 - ▧ RAMPA PNE M02
 - ➔ SENTIDO TRANSITO
 - BI. (BOCA DE LOBO EXISTENTE)
 - ➔ SENTIDO ESCOAMENTO DE AGUA

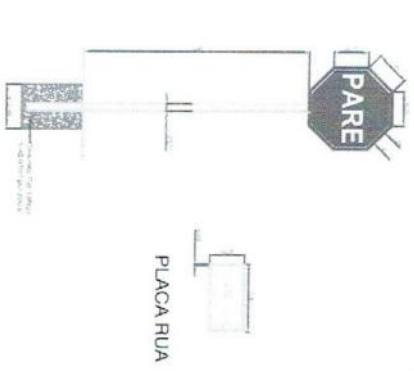
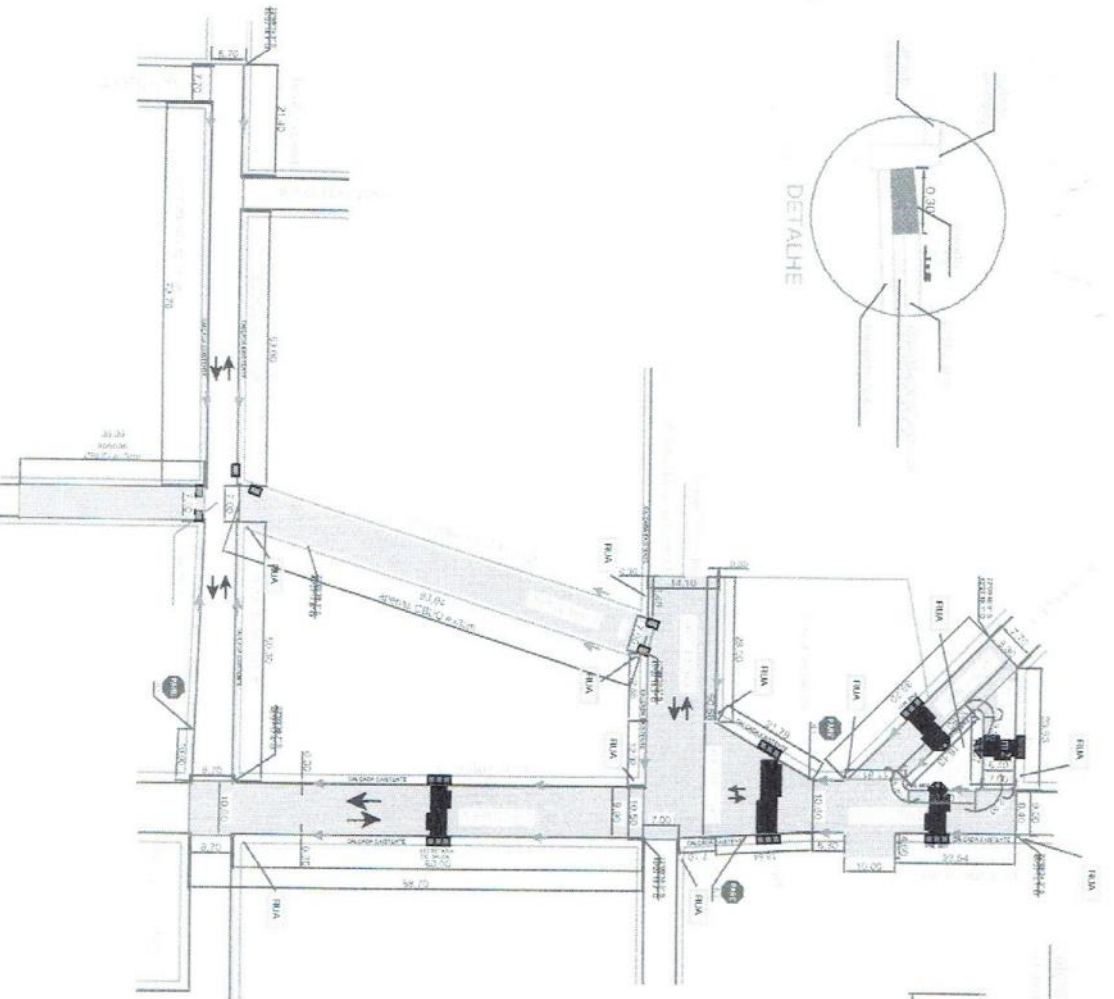

<p>JOSÉ AIRTON PEREIRA PREFEITO MUNICIPAL</p>	<p>Sebastião Rodrigues Florencio Engenheiro Civil CREA 9799 - AMASP</p>
--	--